

# Orion TVT Test Plan

**Author:** Libing wang (libing\_wang@ca.ibm.com)

**Revision:** 1.0

**Date:** May 19th, 2015

## Overview

This test plan covers how to log into Orion as a specific TVT Tester (per language) and how to walk through the OrionUser Interface and pages checking for string translations and to see if those translations are accurate. While the common parts such as edit, setting and shell pages were already covered by the Orion TVT test plan 6.0, this version of the test plan only covers the git repository page and the global search panel as there are a lot of changes since the Orion 6.0 release.

## Part 1 Global Search

### GVT00010 Verify the display strings in the global search panel

In the editor page, press CTRL+SHIFT+H to bring up the global search panel. Verify the display strings as below.

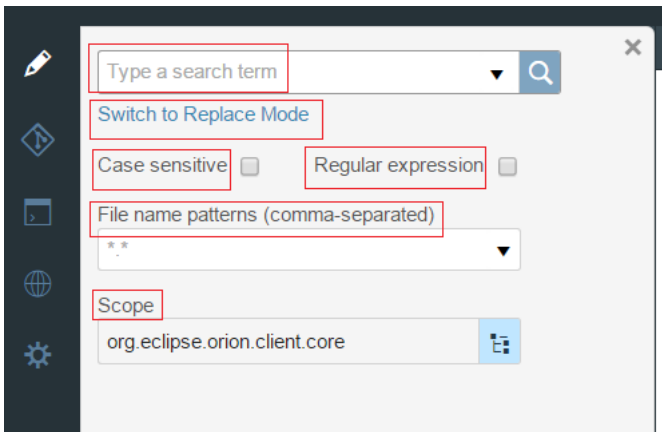

### GVT00020 Verify the display strings in the search result panel

In the search panel, type something to search so that it gives back some results. Verify display strings as below.

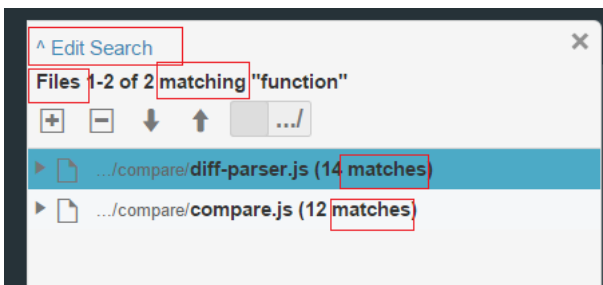

### GVT00030 Verify the tool tips in the search result panel

In the search panel, verify the tool tips strings as below.

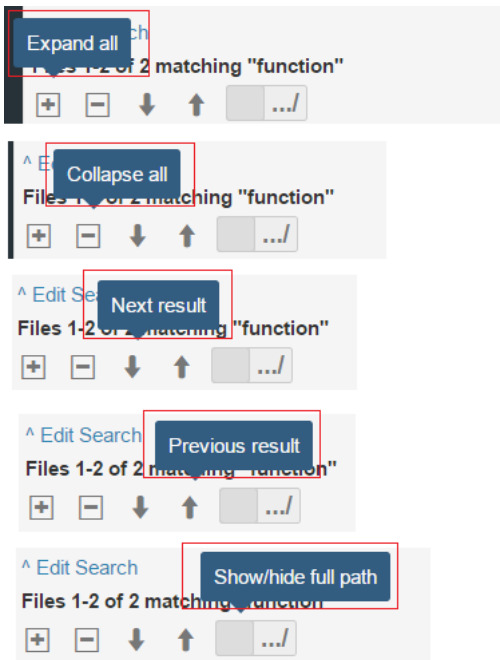

## GVT00040 Verify the display strings and tool tips in the replace mode

In the search result panel, click on "Edit Search" and then click on "Switch to Replace Mode". Verify the display strings and tool tips as below.

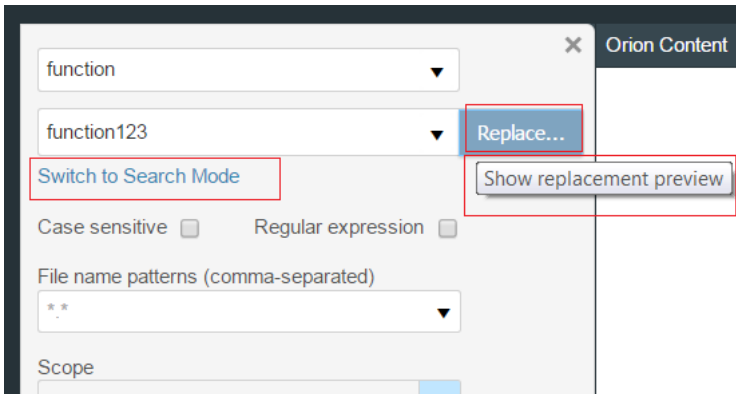

## GVT00050 Verify the display strings and tool tips in the replace preview panel

Type something to replace so that it gives back some results to preview. Verify the display strings and tool tips as below.



## GVT00060 Verify the display strings and tool tips in the replace result panel

In the preview mode panel, click on "Replace Selected". Verify the display strings and tool tips as below.

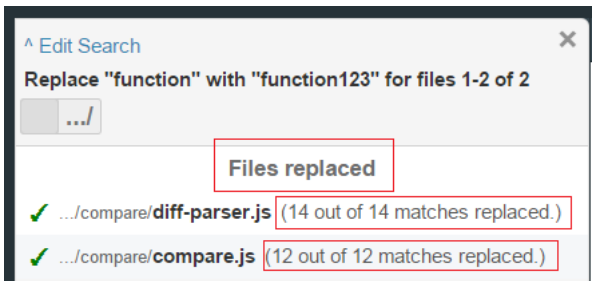

**part 2 - use git repository page to commit changes and test all the tooltips of the buttons.**

2.1 Modify some files in the project and save them. Click on the "Git repository" button on the side bar of the page.

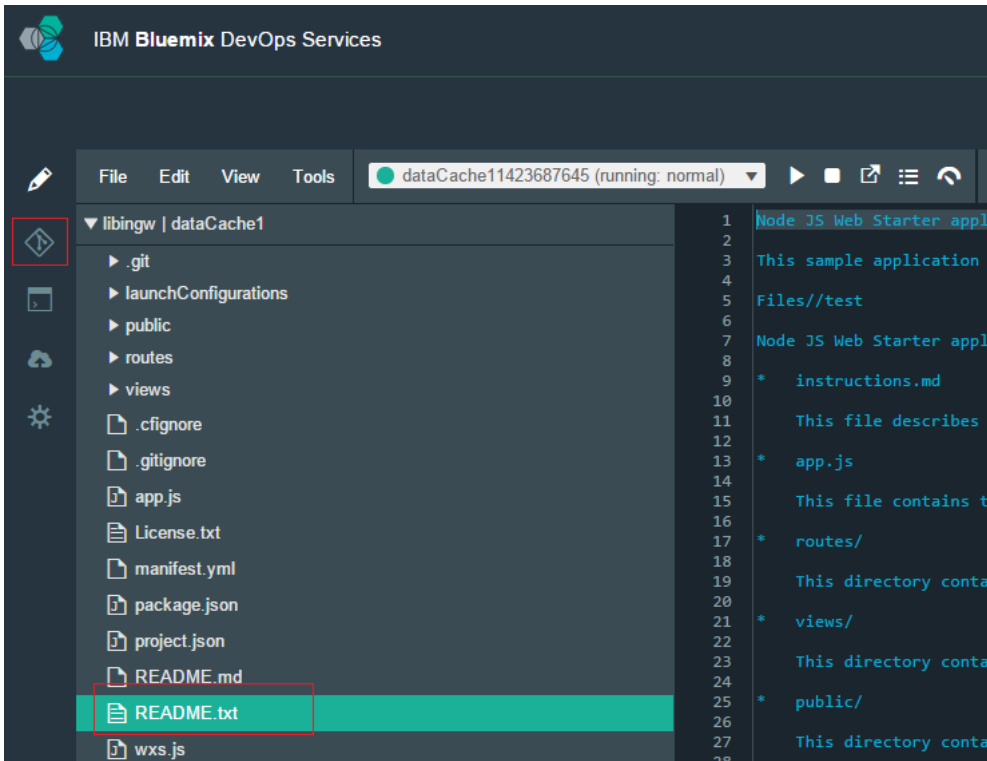

2.2 The Git Repository page is opened as below. The left hand side of the page shows the project revision history while the right hand side shows the current changes.

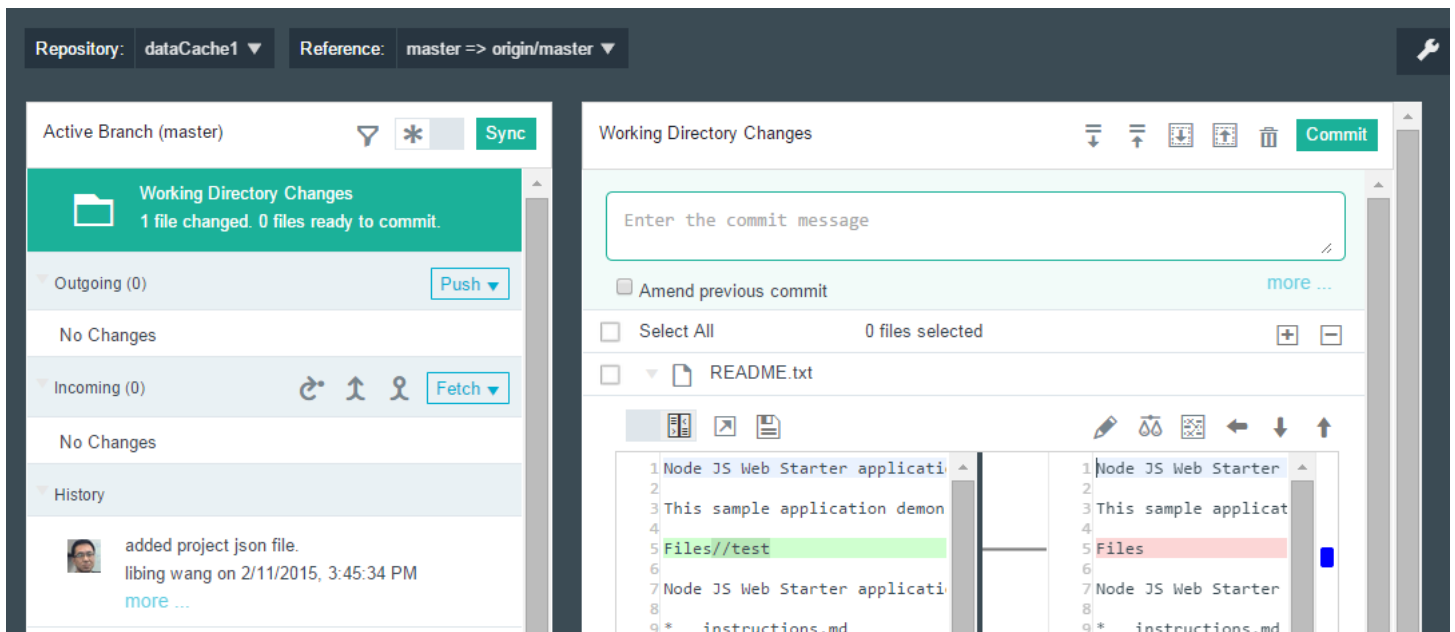

### TVT00080 - Verify the display strings on the left hand side of the page

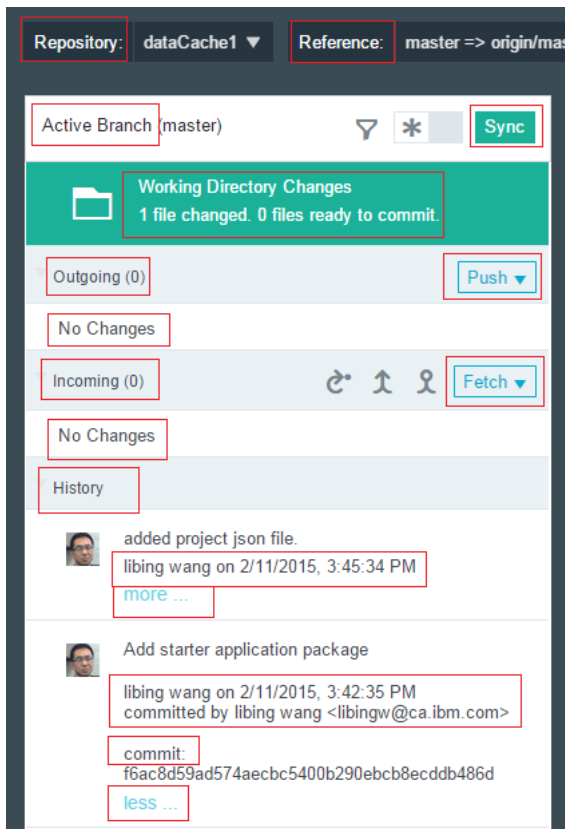

### TVT00090 - Verify the strings in the Repository dropdown panel

Click on the dropdown arrow on the right of the "Repository" label.

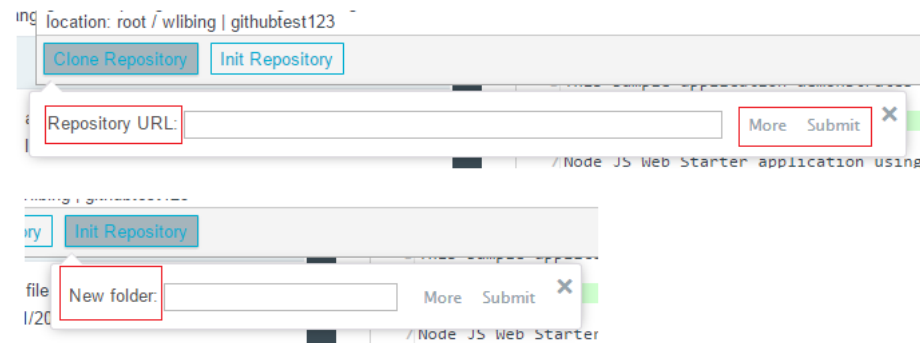
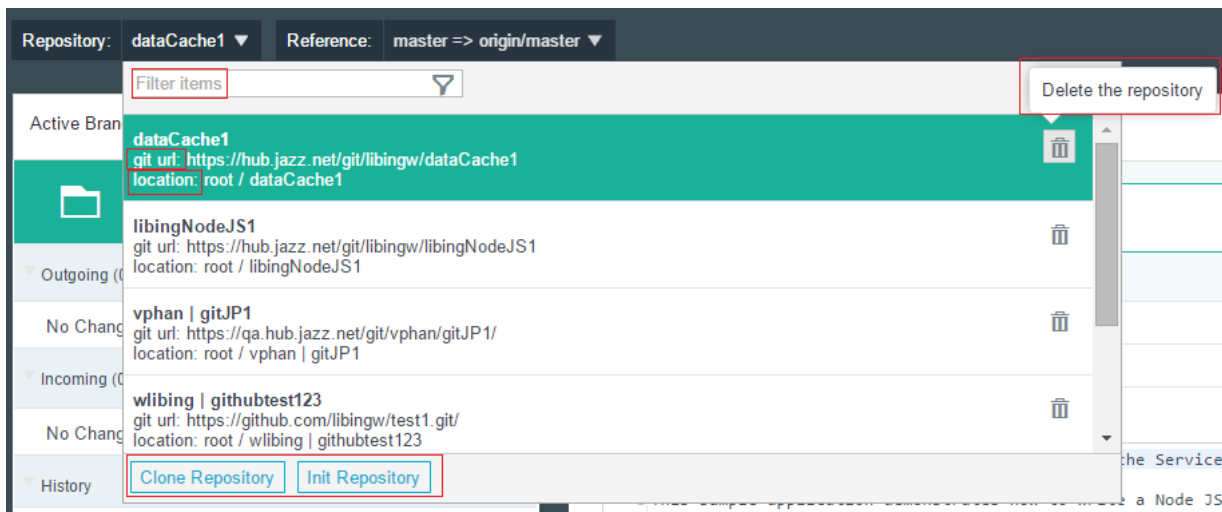

## TVT00100 - Verify the strings in the Reference dropdown panel

Click on the dropdown arrow on the right of the "Reference" label.

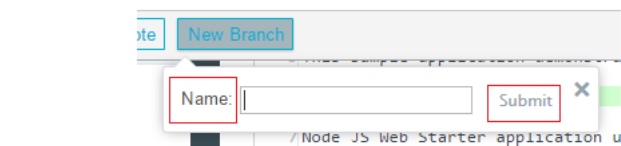
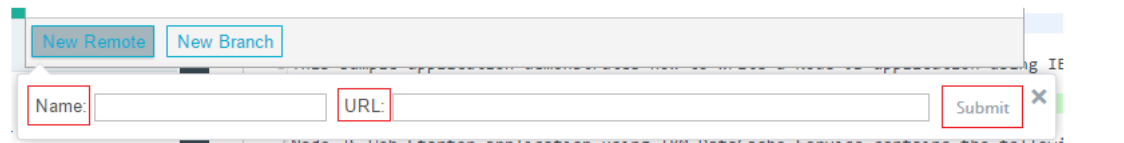
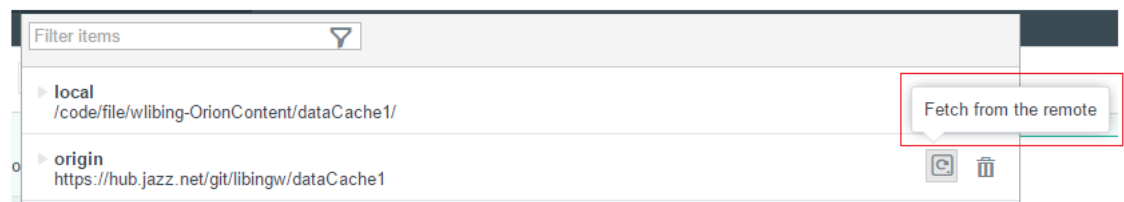
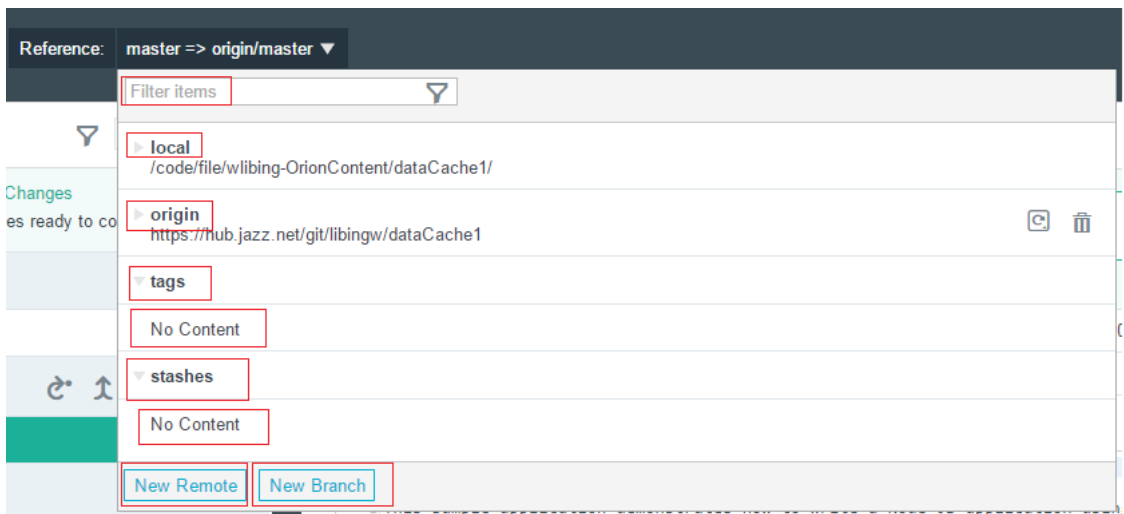

## TVT00100.01 - Verify the strings in the checkout button from the reference dropdown panel

Click on the twistie on the local branch and hover on the checkout button.

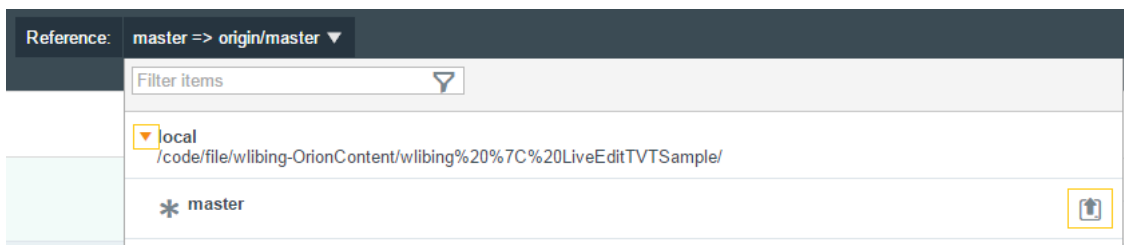

## TVT00110 - Verify the strings of the tooltips on the left hand side of the page

Hover on buttons on the left hand side of the page

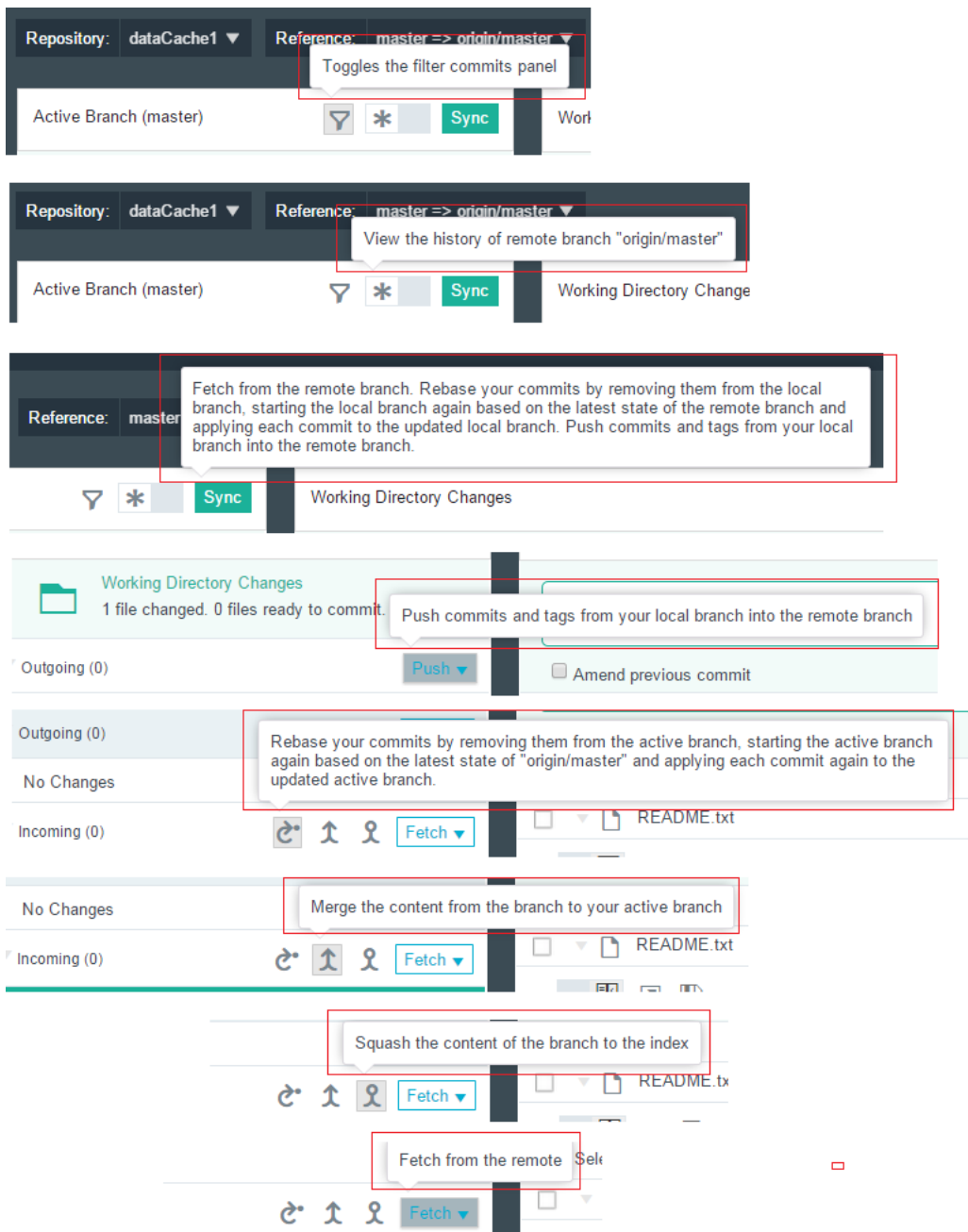

## TVT00110.01 - Verify the strings of the tooltips on the history button on the left hand side of the page

Click on the history button on the left hand side of the page. Hover on the history button again.

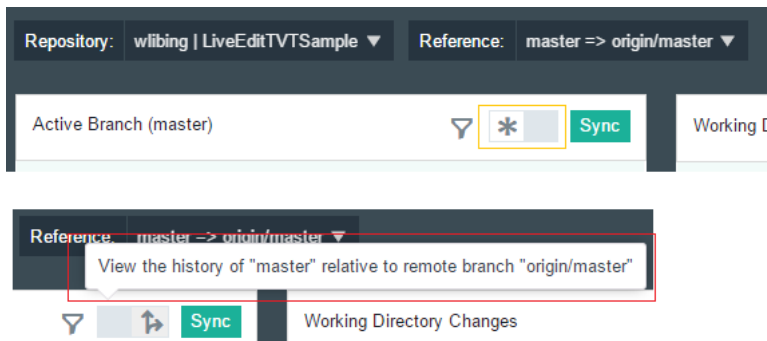

TVT00120 - Verify the strings in the Push dropdown panel

Click on the dropdown arrow on the right of the "Push" button and hover on the 4 items in the dropdown list

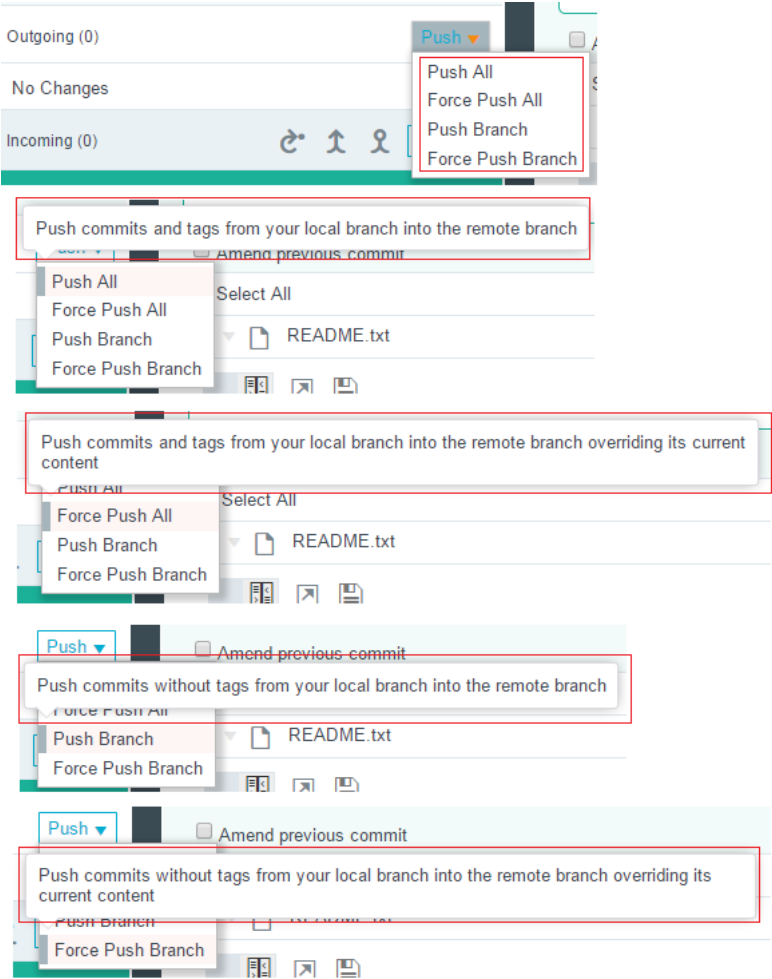

TVT00130 - Verify the strings in the Fetch dropdown panel

Click on the dropdown arrow on the right of the "Fetch" button and hover on the 2 items in the dropdown list

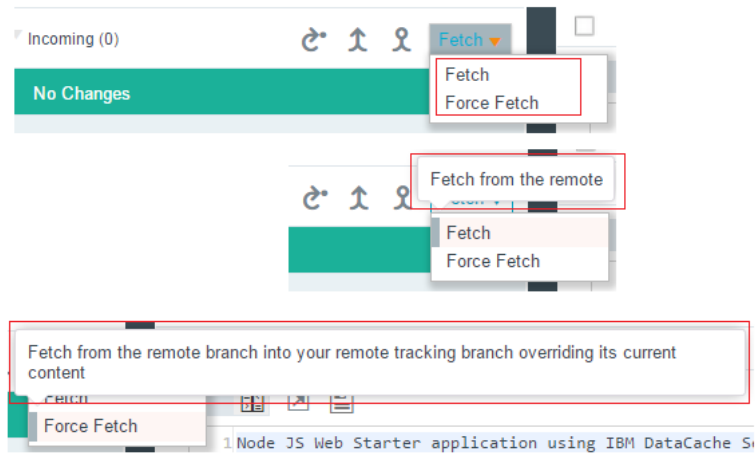

TVT00140 - Verify the display strings on the right hand side of the page

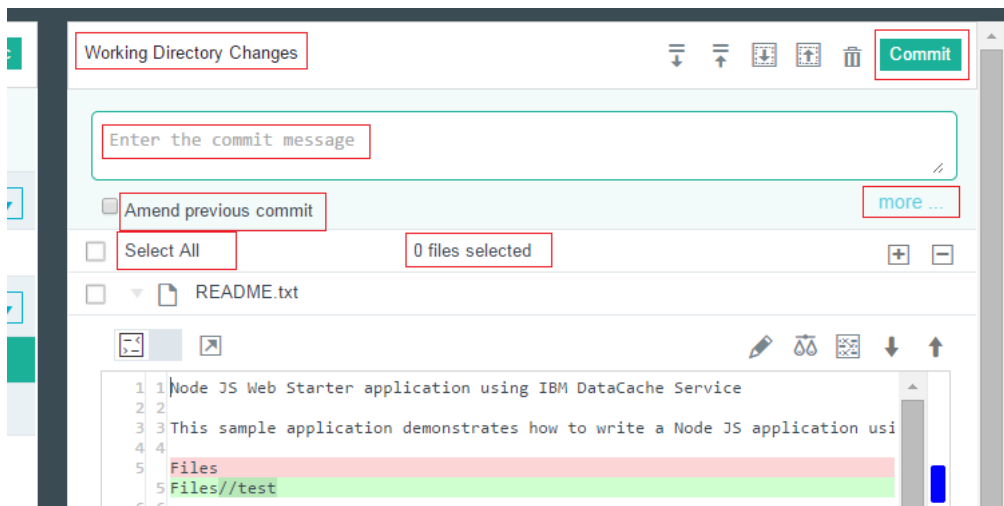

Click on more button

- ☐ Amend previous commit
- ☐ Add Change-ID to message
- ☐ Add Signed-off-by to message

Author:

Name:  Enter author name Email:  Enter author email

Committer:

Name:  Enter committer name Email:  Enter committer email

## TVT00140.01 - Verify the display strings and tooltips on the Git Configuration setting panel

Click on the wrench button on the right of the tool bar.

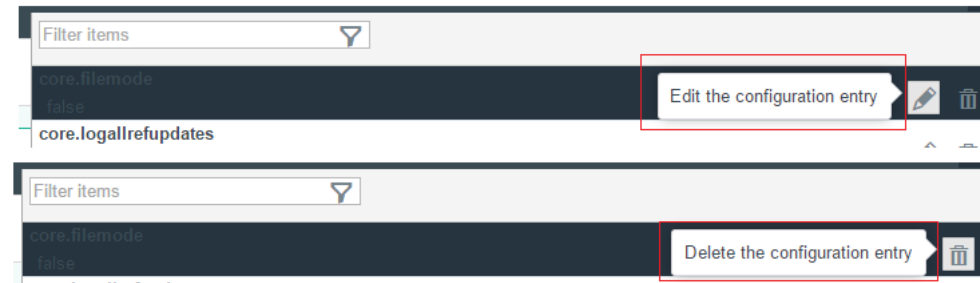
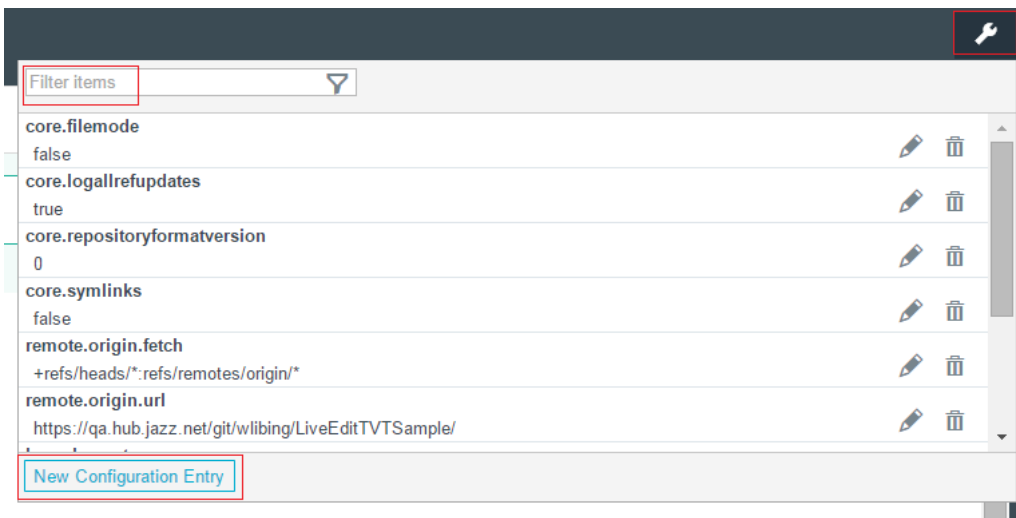

Click on the "New Configuration Entry" button

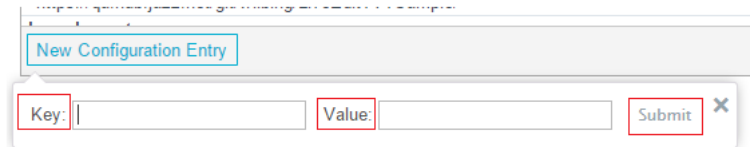

## TVT00150 - Verify the strings of the tooltips on the right hand side of the page

Hover on buttons on the right hand side of the page

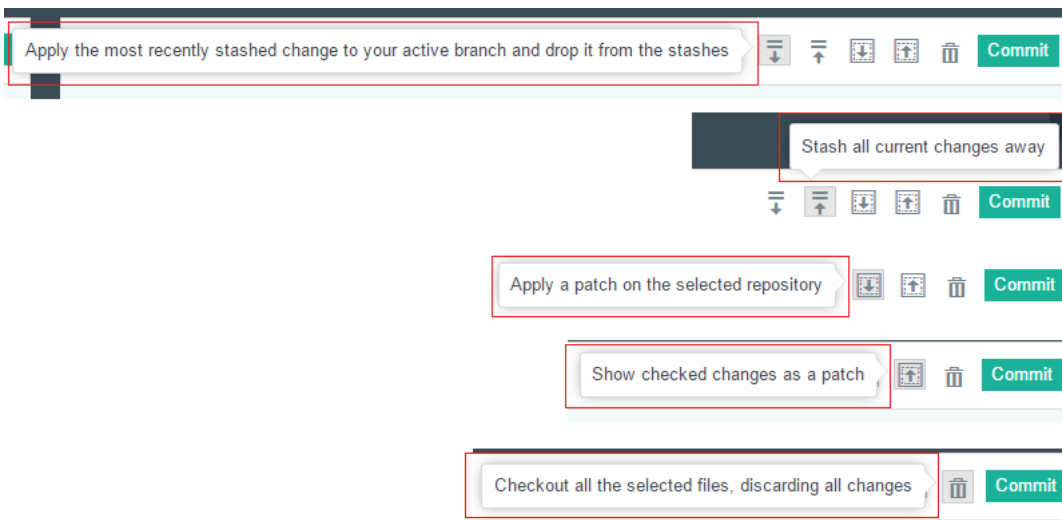

### TVT00150.01 - Verify the strings of the tooltips on the right hand side of the page when a commit on the left hand side is selected

Click on a commit on the left hand side. Hover on buttons on the right hand side of the page

The screenshot displays the Git web interface. On the left, the 'Active Branch (master)' sidebar shows 'Working Directory Changes' (Nothing to commit), 'Outgoing (0)' (Push), 'Incoming (0)' (Fetch), and 'History' (third commit by libing wang). The main area shows a comparison between two commits, with 'Commit (951d46)' selected. A diff for 'manifest.yml' is shown, highlighting changes in the 'name' field. Below the diff, several action buttons are visible, each highlighted with a red box:

- Checkout this commit, creating a local branch based on its contents.
- Reset your active branch to the state of this reference. Discard all staged and unstaged changes.
- Create a tag for the commit
- Apply the change introduced by the commit to your active branch
- Revert changes introduced by the commit into your active branch
- View the tree for this commit
- Show patch for changes in this commit

## TVT00150.02 - Verify the strings on the right hand side of the page when two commits on the left hand side are selected

Click on a commit on the left hand side. Then press CTRL key and click on the second commit.

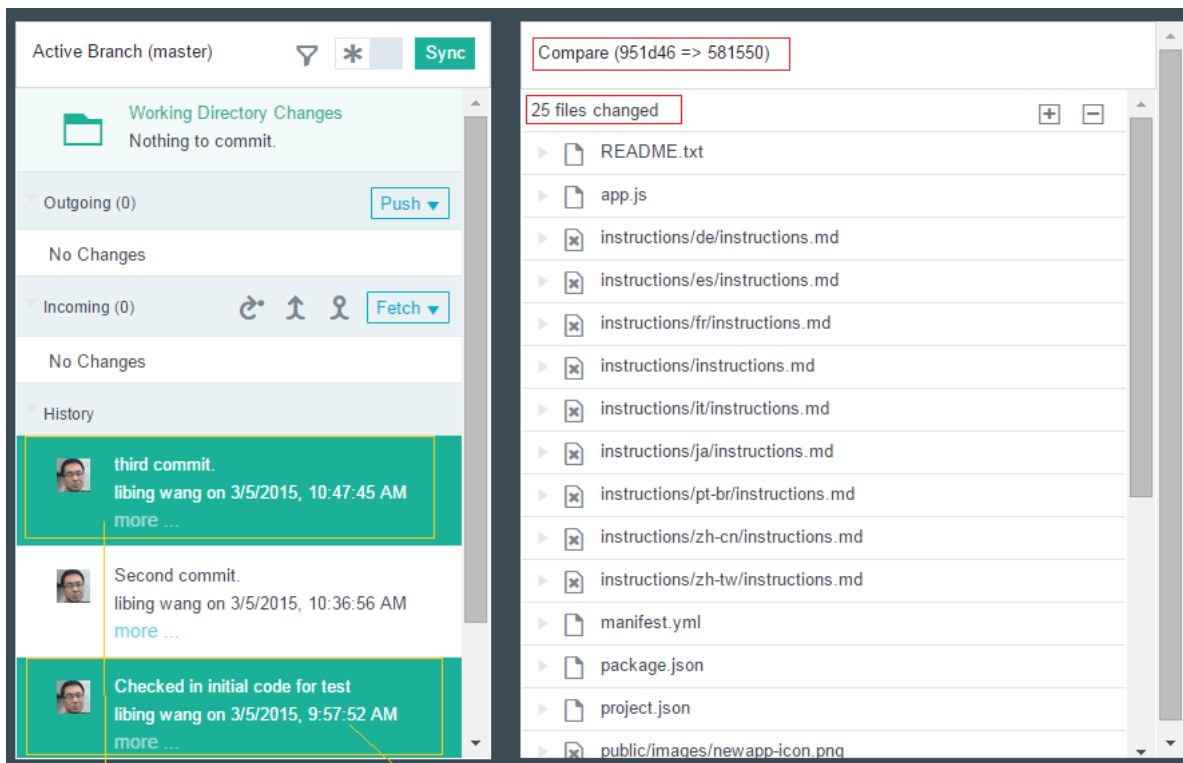

Click on the first commit, then press CTRL key and click on the second commit.

## TVT00160 - Verify the strings of the tooltips on the compare section

Hover on buttons on the compare section of the page

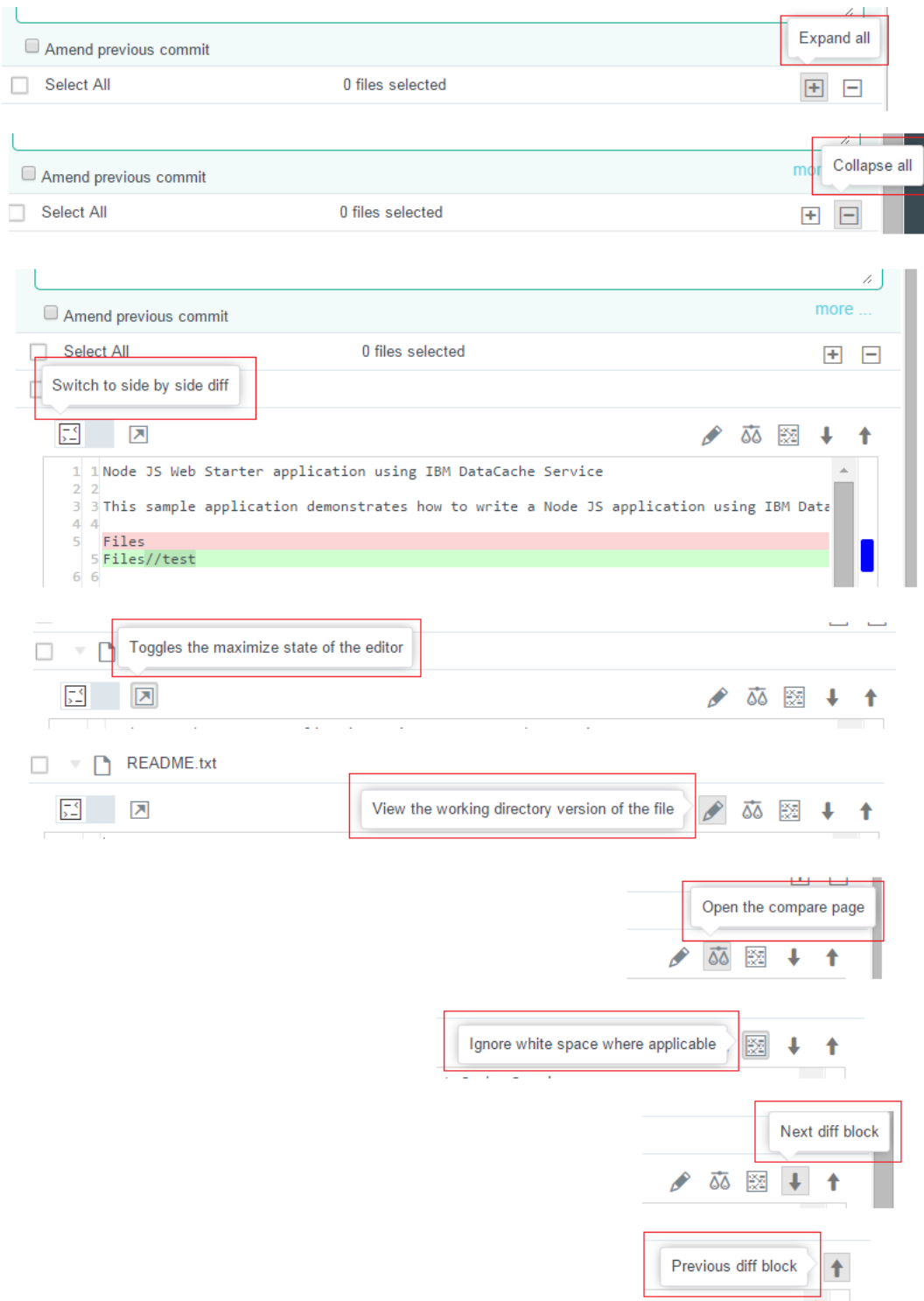

## TVT00170 - Verify the strings of the tooltips on the compare section in side by side mode

Click on the "Switch to side by side" button. Hover on buttons on the compare section of the page

